

CONSTRUCTION BULLETIN

April 28, 2008

Re-directed access as left-turns to Tidewater Way and Kelvin Grove Way closed

On or about May 5, 2008, traffic pattern changes will be implemented that affect access to upper and lower residential areas of Kelvin Grove. The current left-turn access from Highway 99 onto Tidewater Way and Kelvin Grove Way will be eliminated. When construction is completed this fall, a new overpass will provide left-turn access.

Alternate access is being provided with two 'turn-around' locations at the south and north ends of this work area. Construction of a new, temporary turn-around south of the Village of Lions Bay will accommodate southbound driver's access to Kelvin Grove Way. At the north end, northbound travellers or Tidewater Way residents will be directed by signage to the existing turn-around access at Lions Bay Avenue. In addition, the southbound bus stop is being relocated from its current location on Highway 99 to a new position on Tidewater Way. A temporary new painted crosswalk will be installed with elevated ramps to carry pedestrians over the construction area.

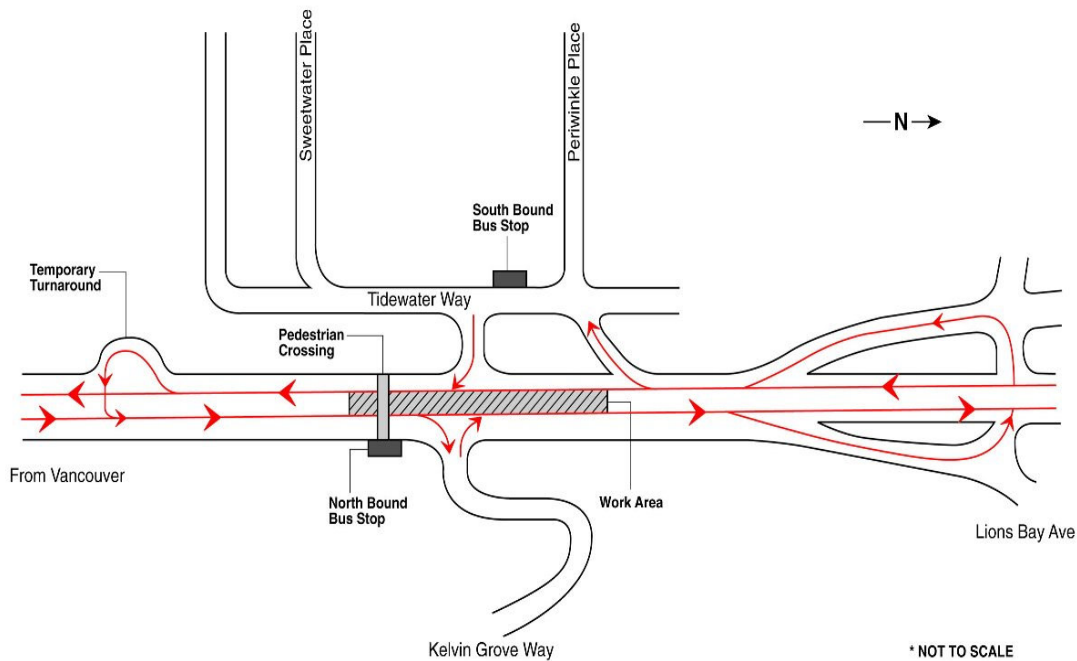

These closures are required to construct the split-grade retaining wall and new overpass structure. Hours of work are 7am – midnight, Monday to Saturday. This temporary left-turn access will be required until fall 2008 when construction of the new split-grade highway separating northbound and southbound traffic and overpass structure is complete.

If you have any questions regarding construction-related noise please call 604-629-8282.

Any questions or comments about the Sea-to-Sky Highway Improvement Project or this bulletin, please contact Scott Roberts, Community Relations Manager at 604-775-1104 or by email at info@seatoskyimprovements.ca For more information on the Sea-to-Sky Highway Improvement Project or closures and delays, please visit the Project website at www.seatoskyimprovements.ca